



SARS-CoV-2 Rapid Antigen Test

Wollerau Pharma Rapid CAT

REF WPCV0101B

TEST PROCEDURE

SECTION 1 - PREPARATION FOR TEST

1. Carefully read the Instructions for Use of **SARS-CoV-2 Rapid Antigen Test** 

2. Check the **EXPIRY DATE** on the sachet.
Discard the test if expiry date has passed.

3. Open the foil pouch and remove the cassette, and gel envelope.

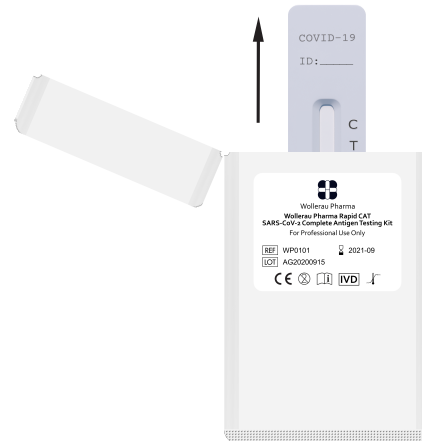
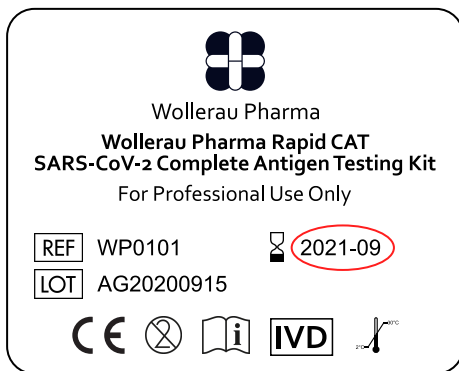

4. Ensure the cassette is undamaged.

SECTION 2 - NASOPHARYNGEAL SWAB PROCEDURE

1. Encourage the patient to blow his her nose to clear nasal passage.
Label the cassette with the patients name, and time of test.
Perform hand hygiene. Put on a mask, eye protection and gloves.

With the person's head in a neutral position

Insert the dry swab through one nostril upwards, along the floor of the nasal passage until you reach the posterior wall of the nasopharynx - generally one half the distance from the corner of the nose to the front of the ear (about 4 to 6 cm)

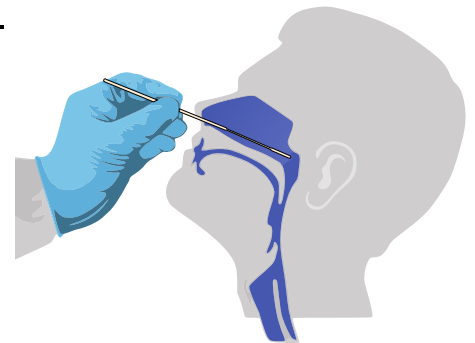

Rotate the swab gently then leave in place a few seconds

Carefully remove the swab without touching the sides of the nostril. Specimens can be collected from both sides using the same swab, but it is not necessary to collect specimens from both sides if the minitip is saturated with fluid from the first collection. If a deviated septum or blockage create difficulty in obtaining the specimen from one nostril, use the same swab to obtain the specimen from the other nostril.

SECTION 3 - PREPARATION FOR TEST

1. Open the reagent tube/dropper

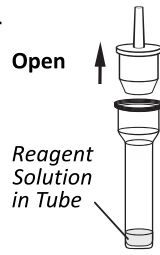

2. Insert the swab in the reagent medium. Leave the swab in the reagent tube/dropper for 1 minute. While squeezing the buffer tube, stir the swab 3 times or more.



3. Remove the swab while squeezing the reagent tube/dropper, to extract liquid from the swab.

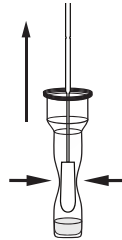

4. Press the nozzle cap tightly onto the reagent tube/dropper.

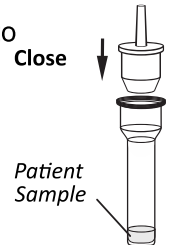

5. Firmly squeeze the reagent tube/dropper to apply three drops of the specimen into the specimen well (S) of the test cassette, then start the timer. Read the test result at 15 to 30 min.

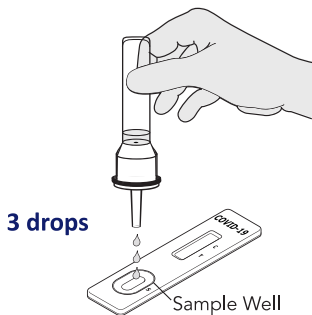

WARNING : Risk of incorrect results.
Do not read the test result after 30 min.

SECTION 4 - INTERPRETING RESULTS

A coloured line (control line) appears in the top section of the cassette to show that the test is working properly. This is the control line (C).

Even if the control line is faint, the test should be considered to have been performed properly. If no control line is visible the test is invalid.

In case of a positive result, a coloured line appears in the lower section of the result window.

This is the test line (T). Even if the test line is very faint or not uniform, the test result should be interpreted as a positive result.

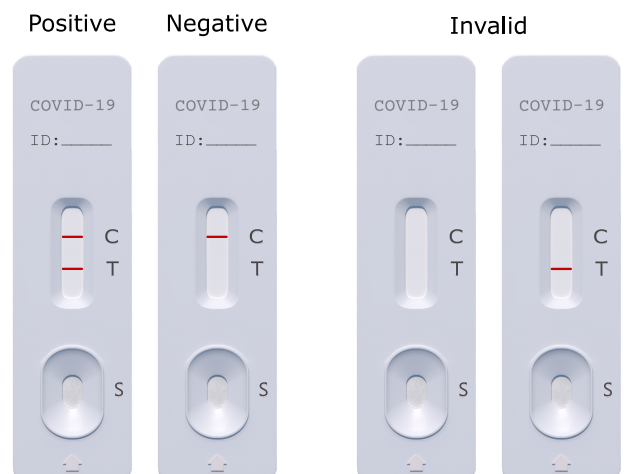

Manufactured by:
Wollerau Pharma Limited
3 Wimpole Street, W1G 9SQ
London, United Kingdom
www.wolleraupharma.com

Product Information:
SARS-CoV-2 Rapid Antigen Test
Wollerau Pharma Rapid CAT
REF WPCV0101B

More Information:
For more information and
contact details please visit:
www.wolleraupharma.com
or scan this QR code →

